

ALVERNO COLLEGE - Milwaukee

800.933.3401 • alverno.edu/visit

Preview Days: Sept. 15, Nov. 11, Jan. 26

Admitted Student Days: Nov. 30, Feb. 22,

Apr. 5

Contact admissions or go to the web address above to schedule individual visits.

BELLIN COLLEGE - Green Bay

800.236.8707 • bellincollege.edu/visit

Preview Days: Oct. 26, Apr. 12

Individual visits are welcomed throughout the year. Call or go to the web address above to schedule an appointment.

BELOIT COLLEGE - Beloit

800.923.5648 • beloit.edu/visit

Admitted Student Open Houses:

Feb. 17-18, Mar. 24-25, Apr. 14-15

Destination Beloit Visit Day: Apr. 19

Transfer Fridays: second and fourth Friday of every month

Personalized visits can be arranged year-round. Visit the web address above for details.

CARDINAL STRITCH UNIVERSITY

- Milwaukee

414.410.4040 • stritch.edu/events

Campus Visit Days: Oct. 26, Apr. 15

Saturdays at Stritch: Sept. 15, Oct. 13,

Nov. 10, Dec. 1, Jan. 26, Feb. 16, Mar. 16,

Apr. 6, May 11, June 22, Aug. 10

Spanish Visit Days: Sept. 29, Nov. 10, Feb. 2, Mar. 30

Admitted Students Days: Nov. 12, Mar. 25

Honors Competition Days: Dec. 7, Feb. 9

Contact admissions to schedule one-to-one visits throughout the year.

CARROLL UNIVERSITY - Waukesha

800.227.7655 • carrollu.edu

Open Houses: Sept. 22, Oct. 27, Nov. 17,

Jan. 26, Feb. 22, Apr. 6, July 13

Individual visits are welcomed throughout the year, Mon.-Fri., 9 a.m.-3 p.m.

Saturday Group Visits: most Saturdays, 10 a.m.-12 p.m.

CARTHAGE COLLEGE - Kenosha

800.351.4058 • carthage.edu

Capture Carthage: Oct. 8, Nov. 9

Visit Day Programs: Mondays, Fridays, and Saturdays throughout the school year

Individual Visits: Mon.-Fri. with appointments at 9 a.m., 11 a.m., 1 p.m.,

or 3 p.m.

CONCORDIA UNIVERSITY WISCONSIN

- Mequon

888.628.9472 • cuw.edu

Visit Days: Oct. 6, Oct. 26, Nov. 3

Athlete Visit Days: Nov. 9, Feb. 22

Junior Days: Mar. 29, Apr. 13

Individual visits are welcomed throughout the year.

EDGEWOOD COLLEGE - Madison

800.444.4861 • edgewood.edu

Preview Days: Oct. 12, Oct. 26

Junior Preview Day: May 4

Sneak Peek Saturdays: Sept. 1, Oct. 6,

Nov. 3, Dec. 1, Feb. 2, Mar. 2, Apr. 20

Admitted Student Days: Feb. 20, Mar. 20, Apr. 10

LAKELAND UNIVERSITY - Sheboygan

800.569.2166 • 920.565.1022

lakeland.edu/visit

Preview Days: Sept. 15, Nov. 3

Individual visits and tours are welcomed throughout the year. Visit the web address above or call to schedule an appointment.

LAWRENCE UNIVERSITY - Appleton

920.832.6500 • lawrence.edu

Fall Open Houses: Oct. 7-8, Oct. 18-19, Nov. 3

Spring Open House: May 20

Summer Open House: July 12, Aug. 2

Admitted Student Days: Feb. 17-18,

Mar. 31-Apr. 1, Apr. 18-19

MARIAN UNIVERSITY - Fond du Lac

920.923.7650 • marianuniversity.edu/visit

Open House Days: Oct. 6, Oct. 26,

Nov. 10, Dec. 7, Mar. 2

Individual visits are offered throughout the year.

MARQUETTE UNIVERSITY - Milwaukee

414.288.7302 • mu.edu/explore

Discovery Days: Sept. 16, Oct. 14

Weekday visits are offered throughout the year with some Saturday options.

← Over for more

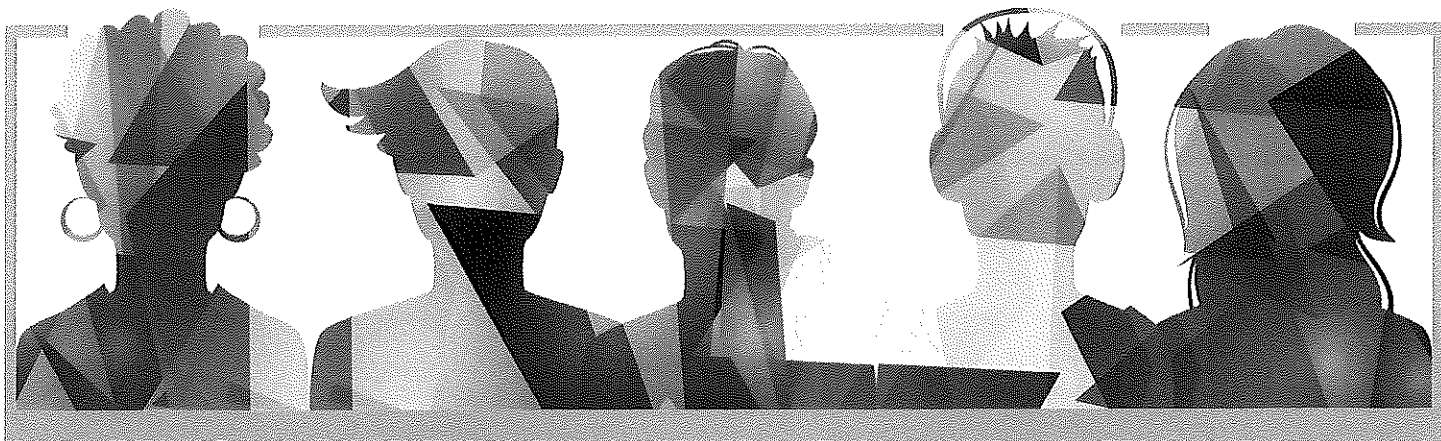

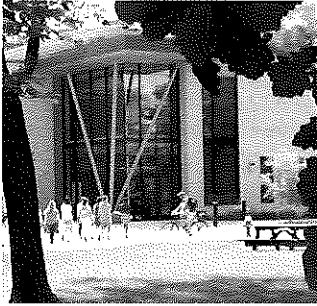
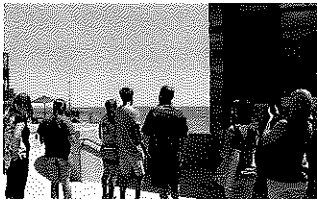

MILWAUKEE INSTITUTE OF ART AND DESIGN - Milwaukee

414.291.8070 • miad.edu

Campus tours and information sessions are available by appointment Mon.-Fri.

Please call or email admissions@miad.edu.

MILWAUKEE SCHOOL OF ENGINEERING - Milwaukee

800.332.6763 • msoe.edu/visit-msoe

Senior Visit Days: Oct. 19, Oct. 26

Junior Visit Days: Jan. 11, Feb. 22, Mar. 8

Open Houses: Sept. 22, Oct. 20, Apr. 27, July 13

MOUNT MARY UNIVERSITY - Milwaukee

414.930.3024 • mtmary.edu/visit

Financing Your Future: Oct. 10

Graduate Studies Open House: Oct. 2, Mar. 19

Preview Days: Oct. 27, Apr. 6

Snapshot Saturdays: Dec. 1, Feb. 9

NORTHLAND COLLEGE - Ashland

715.682.1839 • northland.edu/visit-campus

Visit Days: Oct. 19, Nov. 17, Jan. 21, Mar. 30

Admitted Student Days: Nov. 25-26,

Apr. 12-13

Individual visits can be scheduled Mon.-Sat. at the web address above.

RIPON COLLEGE - Ripon

800.947.4766 • ripon.edu/visit

Ripon Preview Days: Sept. 15, Nov. 2

Accepted Student Days: Apr. 12

Junior Open House: Apr. 28

Call or visit the web address above for individual visits as well as the Saturday visit schedule.

ST. NORBERT COLLEGE - De Pere

800.236.4878 • snc.edu

Fall Visit Days: Oct. 8, Nov. 5

Fall Fridays: Oct. 12, Oct. 19, Oct. 26,

Nov. 2, Nov. 9, Nov. 16

Saturday Sneak Peeks: Sept. 15, Sept. 22,

Sept. 29, Oct. 13, Oct. 20, Nov. 3, Nov. 10,

Dec. 1

Register at snc.edu/admission/events.

Individual visits are welcomed during the week. Schedule at snc.edu/go/visit.

SILVER LAKE COLLEGE - Manitowoc

800.236.4752x175 • 920.686.6175

sl.edu

Campus Visit Days: Sept. 29, Oct. 13,

Nov. 3

Generose Scholarship Competition:

Feb. 16

Accepted Student Day: Mar. 30

Individual appointments are welcome at any time.

WISCONSIN LUTHERAN COLLEGE - Milwaukee

414.443.8810 • wlc.edu/visit

Discovery Days: Sept. 28, Oct. 26, Jan. 21

Personal visits can be arranged most weeks.

Call or go to the web address above for an appointment.

VITERBO UNIVERSITY - La Crosse

800.VITERBO • viterbo.edu/visit

Preview Days: Nov. 10, Jan. 29, Feb. 16, May 3

Accepted Student Day: Apr. 6

Visit the web address above for admission visit events, Saturday visits, as well as weekday opportunities for individual visits.



facebook.com/privatecollegeweek



[@wiprivatecolleges](https://www.instagram.com/wiprivatecolleges)



[@privatecollege](https://twitter.com/privatecollege)

WWW.WISCONSINSPRIVATECOLLEGES.ORG/VISIT

Wisconsin Association of Independent Colleges and Universities

studentaccess@waicu.org • 800.433.4733

122 W. Washington Ave., Ste. 700, Madison, WI 53703